

Parts Manual
45-8002
PL30-1004
04/20/2011

DOTCO[®]

10-04 Series
Light Duty Precision Grinder



| Model Number | Throttle Type | Speed |
|--------------|---------------|--------|
| | | RPM |
| 10N0400 | None | 60,000 |
| 10N0401 | None | 60,000 |
| 10R0400 | Roll | 60,000 |
| 10R0401 | Roll | 60,000 |
| 10R0402 | Roll | 40,000 |
| 10R0412* | Roll | 60,000 |

* Note: Wrenchless Chuck model

For additional product information visit our website at <http://www.apextoolgroup.com>

DOTCO

10-0400 Series Light Duty Precision Grinder

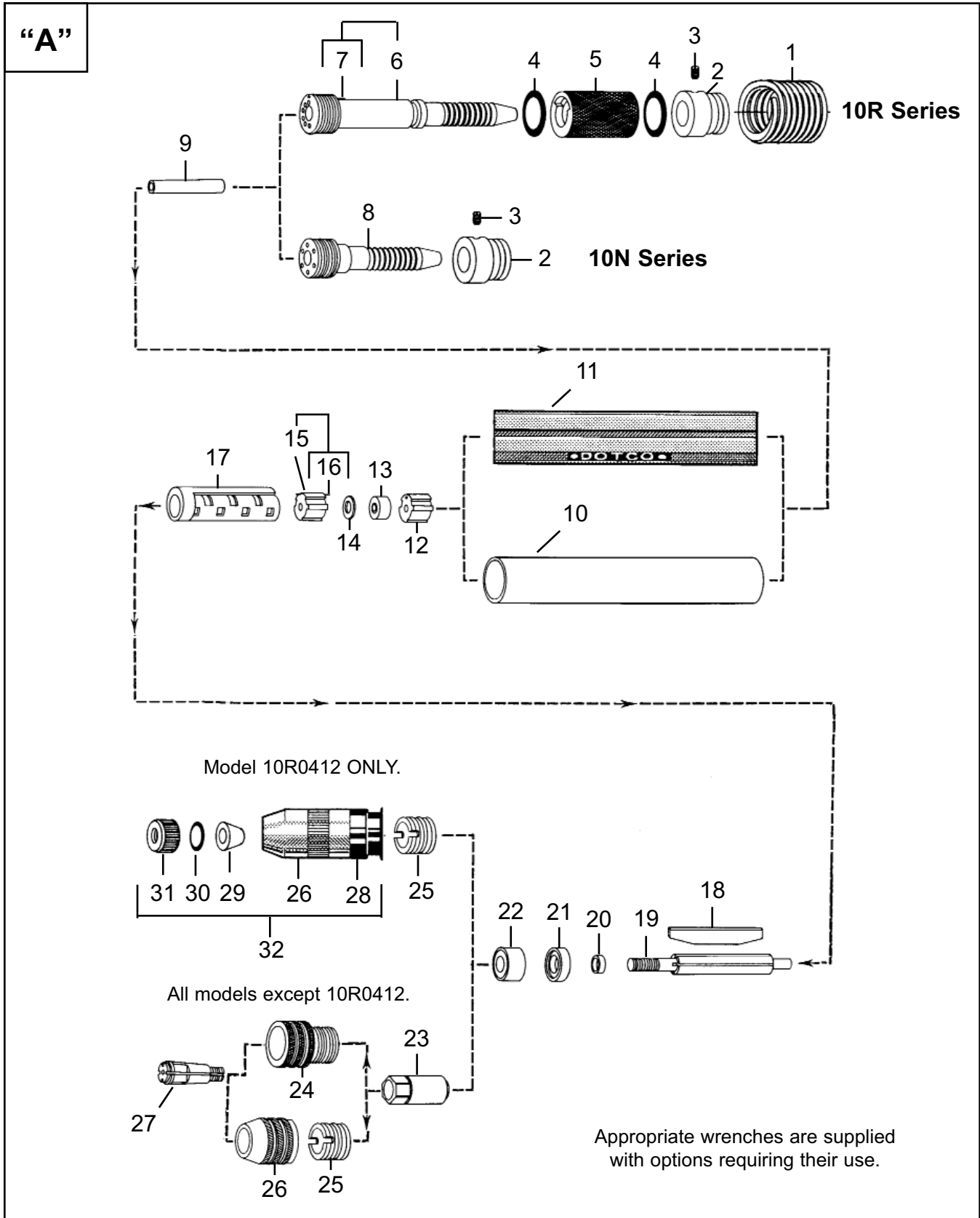

DOTCO

10-0400 Series Light Duty Precision Grinder

PL30-1004
April 6, 2006

Illustration "A" - 10-04 Series Pencil Grinder

| Ref. | Number | # | ● | Kit | EN | DE | FR | ES | IT |
|-------------------------|---------|---|-----|-----|-------------------|--------------------|-------------------------|-------------------------|-------------------------------|
| | | | | | Description | Benennung | Designation | Description | Descrizione |
| 1 | 6061 | 1 | | | Overhose Spring | Druckfeder | Ressort | Resorte | Molla |
| 2 | Table A | 1 | | | Exhaust Adapter | Zwischenstück | Adaptateur | Adaptador | Adattatore |
| 3 | Table A | 1 | | | Set Screw | Stellschraube | Vis de pression | Tornillo fijador | Vite di arresto |
| 4 | 6050 | 2 | | | O-Ring | O-Ring | Joint torique | Anillo "O" | Anello ad O |
| 5 | 01-0935 | 1 | | | Roll Valve | Ventil | Soupape | Válvula | Valvola |
| 6 | 01-0929 | 1 | | | Valve Body | Ventilkörper | Corps de soupape | Cuerpo de válvula | Corpo della valvola |
| 7 | 954 | 1 | | | Pin | Stift | Goupille cylindrique | Pasador | Spina |
| 8 | 950 | 1 | | | Air Inlet Adapter | Zwischenstück | Adaptateur | Adaptador | Adattatore |
| 9 | 948 | 1 | | | Inlet Tube | Rohrmutter | Tube | Tubo | Tubo |
| 10 | Table A | 1 | | | Housing | Gehäuse | Corps | Caja | Corpo |
| 11 | Table A | 1 | | | Housing Cover | Deckel | Couvercle | Cubierta | Coperchio |
| 12 | 969 | 1 | | | Adapter | Zwischenstück | Adaptateur | Adaptador | Adattatore |
| 13 | 510 | 1 | | | Ball Bearing | Kugellager | Roulement à billes | Cojinete de bolas | Cuscinetto a sfera |
| 14 | 949 | 1 | | | Spring Washer | Scheibe | Rondelle | Arandela | Rondella |
| 15 | 979 | 1 | | | Bearing Plate | Tragplatte | Plaque de support | Placa de asiento | Piattello cuscinetto |
| 16 | 1354 | 2 | | | Pin | Stift | Goupille cylindrique | Pasador | Spina |
| 17 | 989 | 1 | | | Cylinder | Zylinder | Cylindre | Cilindro | Cilindro |
| 18 | 1343 | 3 | | | Rotor Blade | Rotorblatt | Palette | Alabe del rotor | Paletta del rotore |
| 19 | 982 | 1 | | | Rotor | Rotor | Rotor | El rotor | Il rotore |
| 20 | 977 | 1 | | | Spacer | Distanzstück | Entretoise | Espaciador | Distanziale |
| 21 | 978 | 1 | | | Bearing Spacer | Lagerdistanzstück | Entretoise de coussinet | Separador de cojinetes | Distanziale cuscinetto |
| 22 | 548 | 1 | | | Ball Bearing | Kugellager | Roulement à billes | Cojinete de bolas | Cuscinetto a sfera |
| 23 | 976 | 1 | | | Chuck Body | Futter Körper | Corps de trou | Bote el Cuerpo | Il Corpo di ciottolo |
| 24 | Table A | 1 | | | Lock Nut | Überwurfmutter | Contre-ecrou molette | Tuerca de fijación | Dado di bloccaggio |
| 25 | Table A | 1 | | | Lock Ring | Verschlussring | Bague de verrouillage | Anillo de cierre | Anello di bloccaggio |
| 26 | Table A | 1 | | | Collet Guard | Schutzvorrichtung | Protection | Guarda | Protezione |
| 27 | 100 | 1 | | | Collet (1/8") | Futter | Douille de serrage | Boquilla | Bussola di chiusura |
| | 102 | 1 | | | Collet (3/32") | Futter | Douille de serrage | Boquilla | Bussola di chiusura |
| 28 | 902 | 1 | | | Guard Lock Ring | Verschlussring | Bague de verrouillage | Anillo de cierre | Anello di bloccaggio |
| 29 | 901 | 1 | | | Wedge | Keil | Cale | Cuña | Cuneo |
| 30 | 913 | 1 | | | O-Ring | O-Ring | Joint torique | Anillo "O" | Anello ad O |
| 31 | 904 | 1 | | | Lock Nut | Überwurfmutter | Contre-ecrou molette | Tuerca de fijación | Dado di bloccaggio |
| 32 | 956 | 1 | (1) | | Wrenchless Chuck | Klammer | Serre-joint | La abrazadera | Il morsetto |
| | 957 | 1 | (1) | | Wrenchless Chuck | Klammer | Serre-joint | La abrazadera | Il morsetto |
| | 958 | 1 | (1) | | Wrenchless Chuck | Klammer | Serre-joint | La abrazadera | Il morsetto |
| Parts Not Shown: | | | | | | | | | |
| -- | 45-6003 | 1 | | | Overhose | Schlauchabdeckung | Couverture de tuyau | Cubierta de la manguera | Copertura del tubo flessibile |
| -- | 45-0948 | 1 | | | Intake Hose | Schlauch | Tuyau | Manguera | Tubo |
| -- | 14-0803 | 1 | (2) | | Wrench (3/16") | Schraubenschlüssel | Clé plate | La llave | La chiave |
| -- | 14-0822 | 1 | (2) | | Wrench (11/32") | Schraubenschlüssel | Clé plate | La llave | La chiave |

(#) Quantity / Stückzahl / Quantité / Cantidad / Quantità

(1) Wrenchless Chuck capacities: 956 = 2.35mm, 957 = 3mm, 958 = 1/8"

(2) All models except 10R0412

Table "A"

| Ref. | Description | Qty. | 10N0400 | Qty. | 10N0401 | Qty. | 10R0400 10R0402 | Qty. | 10R0401 | Qty. | 10R0412 |
|------|---------------|------|---------|------|---------|------|--------------------|------|---------|------|---------|
| 2 | Adapter | 1 | 971 | 1 | 971 | 1 | 01-0917 | 1 | 01-0917 | 1 | 01-0917 |
| 3 | Set Screw | 1 | 6063 | 1 | 6063 | 1 | 6057 | 1 | 6057 | 1 | 6057 |
| 10 | Housing | 1 | 972 | 1 | 972 | 1 | 972 | 1 | 972 | 1 | 952 |
| 11 | Housing Cover | | --- | | --- | | --- | | --- | | 920 |
| 24 | Lock Nut | 1 | 970 | | --- | 1 | 970 | | --- | | --- |
| 25 | Lock Ring | | --- | 1 | 967 | | --- | 1 | 967 | 1 | 903 |
| 26 | Collet Guard | | --- | 1 | 1830 | | --- | 1 | 1830 | 1 | 905 |

Sales & Service Centers

Note: All locations may not service all products. Please contact the nearest Sales & Service Center for the appropriate facility to handle your service requirements.

Dallas, TX
**Apex Tool Group
Sales & Service Center**
1470 Post & Paddock
Grand Prairie, TX 75050
Tel: 972-641-9563
Fax: 972-641-9674

Detroit, MI
**Apex Tool Group
Sales & Service Center**
2630 Superior Court
Auburn Hills, MI 48326
Tel: 248-391-3700
Fax: 248-391-7824

Houston, TX
**Apex Tool Group
Sales & Service Center**
6550 West Sam Houston
Parkway North, Suite 200
Houston, TX 77041
Tel: 713-849-2364
Fax: 713-849-2047

Lexington, SC
Apex Tool Group
670 Industrial Drive
Lexington, SC 29072
Tel: 800-845-5629
Tel: 803-951-7544
Fax: 803-358-7681

Los Angeles, CA
**Apex Tool Group
Sales & Service Center**
15503 Blackburn Avenue
Norwalk, CA 90650
Tel: 562-623-4457
Fax: 562-802-1718

Seattle, WA
**Apex Tool Group
Sales & Service Center**
2865 152nd Avenue N.E.
Redmond, WA 98052
Tel: 425-497-0476
Fax: 425-497-0496

York, PA
**Apex Tool Group
Sales & Service Center**
3990 East Market Street
York, PA 17402
Tel: 717-755-2933
Fax: 717-757-5063

Canada
**Apex Tool Group
Sales & Service Center**
5925 McLaughlin Road
Mississauga, Ont. L5R 1B8
Canada
Tel: 905-501-4785
Fax: 905-501-4786

Germany
Cooper Power Tools
GmbH & Co. OHG
a company of
Apex Tool Group, LLC
Industriestraße 1
73463 Westhausen
Germany
Tel: +49 (0) 73 63 81 0
Fax: +49 (0) 73 63 81 222

England
Cooper Power Tools
GmbH & Co. OHG
a company of
Apex Tool Group, LLC
C/O Spline Gauges
Piccadilly, Tamworth
Staffordshire B78 2ER
United Kingdom
Tel: +44 1827 8741 28
Fax: +44 1827 8741 28

France
Cooper Power Tools SAS
a company of
Apex Tool Group, LLC
25 rue Maurice Chevalier
77330 Ozoir-La-Ferrière
France
Tel: +33 1 6443 2200
Fax: +33 1 6443 1717

China
Cooper (China) Co., Ltd.
a company of
Apex Tool Group, LLC
955 Sheng Li Road,
Heqing Pudong, Shanghai
China 201201
Tel: +86-21-28994176
Fax: +86-21-51118446

Mexico
Cooper Tools
de México S.A. de C.V.
a company of
Apex Tool Group, LLC
Vialidad El Pueblito #103
Parque Industrial Querétaro
Querétaro, QRO 76220
Mexico
Tel: +52 (442) 211-3800
Fax: +52 (442) 103-0443

Brazil
Cooper Tools Industrial Ltda.
a company of
Apex Tool Group, LLC
Av. Liberdade, 4055
Zona Industrial - Iporanga
SP Brazil
Tel: +55 15 2383929
Fax: +55 15 2383260

Hungary
Cooper Tools Hungaria Kft.
a company of
Apex Tool Group, LLC
Berkenyefa sor 7
Pf: 640
9027 Györ
Hungary
Tel: +36 96 66 1383
Fax: +36 96 66 1135

Available Now At PneumaticToolsOnline.com

For Quotes or Questions Call Our Sales Engineers At 1-800-353-4676

ZAMPINI INDUSTRIAL

Apex Tool Group, LLC
1000 Lufkin Road
Apex, NC 27539
Phone: 919-387-0099
Fax: 919-387-2614
www.apextoolgroup.com

DOTCO®