

Desoutter



Industrial Tools



Balancers
Support your
Productivity

More Than Productivity



General information

■ Spring Retractors / Reaction Free Balancers - Differences?



Spring retractor:

- Cylindrical shape
- Automatic load retraction
- Working area remains free



Reaction free:

- Conical shape
- Constant retracting force
- Holds the selected height

■ Standard Security Features: DF & DFL Series



Balancers - D & HU series



- Steel housing
- Nylon cable
- Additional support chain included

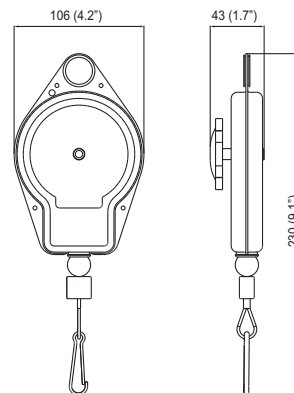

BALANCERS - 1DU - 5DU

| MODEL | PART NUMBER | LOAD RANGE | | | | CABLE TRAVEL | | WEIGHT | |
|-------|-------------|---------------|-----|---------------|-----|--------------|-----|--------|-----|
| | | MIN. CAPACITY | | MAX. CAPACITY | | m | ft | kg | lb |
| | | kg | lb | kg | lb | | | | |
| 1DU | 52542 | 0 | 0 | 0.5 | 1.1 | 1.5 | 4.9 | 0.6 | 1.3 |
| 2DU | 50522 | 0.5 | 1.1 | 1.0 | 2.2 | 1.5 | 4.9 | 0.6 | 1.3 |
| 2DUS | 54532 | 0.5 | 1.1 | 1.0 | 2.2 | 3.0 | 9.8 | 0.6 | 1.3 |
| 3DU | 52862 | 1.0 | 2.2 | 1.5 | 3.3 | 1.5 | 4.9 | 0.6 | 1.3 |
| 4DU | 50532 | 1.0 | 2.2 | 2.0 | 4.4 | 1.5 | 4.9 | 0.6 | 1.3 |
| 5DU | 50542 | 1.4 | 3.1 | 2.4 | 5.3 | 1.5 | 4.9 | 0.6 | 1.3 |



- Steel housing
- Steel cable
- Additional support chain included
- 10S / 15S / 22S with drum lock feature: operates only on spring failure

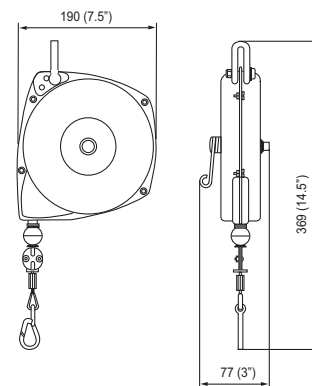

BALANCERS - 10D/S - 22D/S

| MODEL | PART NUMBER | LOAD RANGE | | | | CABLE TRAVEL | | WEIGHT | |
|-------|-------------|---------------|------|---------------|------|--------------|-----|--------|-----|
| | | MIN. CAPACITY | | MAX. CAPACITY | | m | ft | kg | lb |
| | | kg | lb | kg | lb | | | | |
| 10D | 50052 | 2.5 | 5.5 | 5.0 | 11.0 | 2.4 | 7.8 | 2.7 | 6.0 |
| 15D | 50062 | 5.0 | 11.0 | 7.0 | 15.4 | 2.4 | 7.8 | 3.2 | 7.1 |
| 22D | 50072 | 6.0 | 13.2 | 10.0 | 22.0 | 2.4 | 7.8 | 3.2 | 7.1 |
| 10S* | 50572 | 2.0 | 4.4 | 5.0 | 11.0 | 2.4 | 7.8 | 2.7 | 6.0 |
| 15S* | 50582 | 5.0 | 11.0 | 7.0 | 15.4 | 2.4 | 7.8 | 3.2 | 7.1 |
| 22S* | 50592 | 6.0 | 13.2 | 10.0 | 22.0 | 2.4 | 7.8 | 3.2 | 7.1 |

* Balancers with drum lock features



- Steel housing
- Additional support chain included
- Polyurethane hose
- 1/4" in. thread

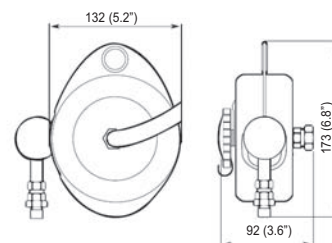

HOSE BALANCERS - 1HU - 4HU

| MODEL | PART NUMBER | LOAD RANGE | | | | HOSE TRAVEL | | HOSE ID | | WEIGHT | |
|-------|-------------|---------------|-----|---------------|-----|-------------|-----|---------|-----|--------|-----|
| | | MIN. CAPACITY | | MAX. CAPACITY | | m | ft | mm | in. | kg | lb |
| | | kg | lb | kg | lb | | | | | | |
| 1HU | 52552 | 0.5 | 1.1 | 0.5 | 1.1 | 1.5 | 4.9 | 6.5 | 1/4 | 1.2 | 2.6 |
| 3HU | 50552 | 0.5 | 1.1 | 1.4 | 3.1 | 1.0 | 3.3 | 6.5 | 1/4 | 1.2 | 2.6 |
| 4HU | 50562 | 0.7 | 1.5 | 2.0 | 4.4 | 1.0 | 3.3 | 6.5 | 1/4 | 3.3 | 7.3 |

Flow rate: 7.1 l/s (15cfm)

Balancers - R & DF series



- Reaction free: holds the load weightless throughout the entire cable length
- Plastic housing & nylon cable: 2R, 4R
- Steel housing & steel cable: 5R, 10R
- Cable locks in the event of spring failure

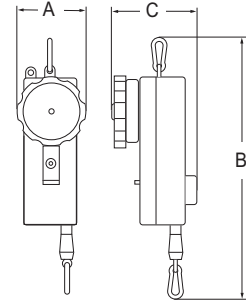

BALANCERS - 2R - 10R - REACTION FREE SELF-LOCK

| MODEL | PART NUMBER | LOAD RANGE | | | | CABLE TRAVEL | | WEIGHT | | DIMENSIONS | | | | | |
|-------|-------------|---------------|-----|---------------|------|--------------|-----|--------|-----|------------|-----|-----|------|-----|-----|
| | | MIN. CAPACITY | | MAX. CAPACITY | | m | ft | kg | lb | A | B | C | | | |
| | | kg | lb | kg | lb | | | | | | | | | mm | in. |
| 2R | 54422 | 0.7 | 1.5 | 1.3 | 2.9 | 1.7 | 5.5 | 0.5 | 1.1 | 72 | 2.8 | 245 | 9.6 | 108 | 4.3 |
| 4R | 54432 | 1.0 | 2.2 | 2.0 | 4.4 | 1.7 | 5.5 | 0.5 | 1.1 | 72 | 2.8 | 245 | 9.6 | 108 | 4.3 |
| 5R | 54442 | 1.7 | 3.7 | 3.5 | 7.7 | 2.4 | 7.8 | 2.3 | 5.1 | 116 | 4.6 | 427 | 16.8 | 155 | 6.1 |
| 10R | 54452 | 3.0 | 6.6 | 6.0 | 13.2 | 2.4 | 7.8 | 2.3 | 5.1 | 116 | 4.6 | 427 | 16.8 | 155 | 6.1 |



- Reaction free: holds the load weightless throughout the entire cable length
- Rigid and impact-resistant plastic housing
- 360° swiveling safety hook for isolated suspension
- Screw-type safety hook for load suspension
- Standard safety chain
- Spring fracture safeguard, integrated drum lock

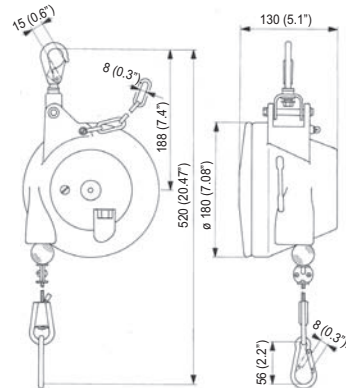

BALANCERS - 5DF - 21DF

| MODEL | PART NUMBER | LOAD RANGE | | | | CABLE TRAVEL | | WEIGHT | |
|-------|---------------|---------------|------|---------------|------|--------------|-----|--------|-----|
| | | MIN. CAPACITY | | MAX. CAPACITY | | m | ft | kg | lb |
| | | kg | lb | kg | lb | | | | |
| 5DF | 615 805 011 0 | 3.0 | 6.6 | 5.0 | 11.0 | 2.0 | 6.6 | 2.9 | 6.4 |
| 7DF | 615 805 012 0 | 4.5 | 9.9 | 7.0 | 15.4 | 2.0 | 6.6 | 3.1 | 6.8 |
| 10DF | 615 805 013 0 | 6.0 | 13.2 | 10.0 | 22.0 | 2.0 | 6.6 | 3.2 | 7.1 |
| 14DF | 615 805 014 0 | 9.0 | 19.8 | 14.0 | 30.9 | 2.0 | 6.6 | 3.4 | 7.5 |
| 17DF | 615 805 015 0 | 13.0 | 28.7 | 17.0 | 37.5 | 2.0 | 6.6 | 3.6 | 7.9 |
| 21DF | 615 805 016 0 | 16.0 | 35.3 | 21.0 | 46.3 | 2.0 | 6.6 | 3.8 | 8.4 |



- Reaction free: holds the load weightless throughout the entire cable length
- Rigid and impact-resistant aluminum housing
- 360° swiveling screw-type safety hook
- Screw-type safety hook for load suspension
- Standard safety chain
- Spring fracture safeguard, integrated drum lock

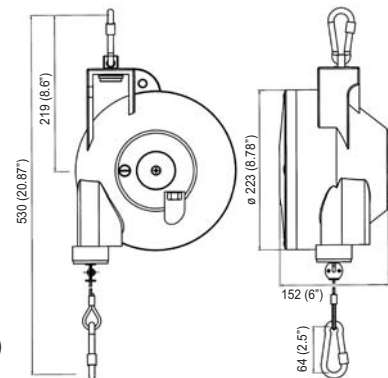

BALANCERS - 25DF - 55DF

| MODEL | PART NUMBER | LOAD RANGE | | | | CABLE TRAVEL | | WEIGHT | |
|-------|---------------|---------------|------|---------------|-------|--------------|-----|--------|------|
| | | MIN. CAPACITY | | MAX. CAPACITY | | m | ft | kg | lb |
| | | kg | lb | kg | lb | | | | |
| 25DF | 615 805 017 0 | 15.0 | 33.1 | 25.0 | 55.1 | 2.0 | 6.6 | 7.8 | 17.2 |
| 35DF | 615 805 018 0 | 25.0 | 55.1 | 35.0 | 77.2 | 2.0 | 6.6 | 8.9 | 16.6 |
| 45DF | 615 805 019 0 | 35.0 | 77.2 | 45.0 | 99.2 | 2.0 | 6.6 | 9.5 | 20.9 |
| 55DF | 615 805 020 0 | 45.0 | 99.2 | 55.0 | 121.2 | 2.0 | 6.6 | 9.7 | 21.4 |

Heavy duty balancers - DFL series



- Reaction free: holds the load weightless throughout the entire cable length
- Rigid and impact-resistant aluminum housing
- 360° swiveling safety hook
- Cable extension limit stop for overload protection
- Screw-type safety hook for load suspension
- Standard safety chain
- Standard spring fracture safeguard, integrated drum lock
- Ferrule for securing cable end
- Freewheel device for protection against handling errors

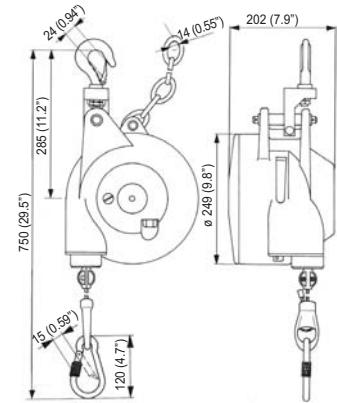

Max.
100 kg (220lb)

BALANCERS - 20DFL - 100DFL

| MODEL | PART NUMBER | LOAD RANGE | | | | CABLE TRAVEL | | WEIGHT | |
|--------|---------------|---------------|-------|---------------|-------|--------------|-----|--------|------|
| | | MIN. CAPACITY | | MAX. CAPACITY | | m | ft | kg | lb |
| 20DFL | 615 805 021 0 | 12 | 26.5 | 20 | 44.1 | 2.0 | 6.6 | 14.8 | 32.6 |
| 30DFL | 615 805 022 0 | 20 | 44.1 | 30 | 66.1 | 2.0 | 6.6 | 15.2 | 33.5 |
| 45DFL | 615 805 023 0 | 30 | 66.1 | 45 | 99.2 | 2.0 | 6.6 | 16.9 | 37.2 |
| 60DFL | 615 805 024 0 | 45 | 99.2 | 60 | 132.3 | 2.0 | 6.6 | 17.3 | 38.1 |
| 75DFL | 615 805 025 0 | 60 | 132.3 | 75 | 165.3 | 2.0 | 6.6 | 18.7 | 41.2 |
| 90DFL | 615 805 026 0 | 75 | 165.3 | 90 | 198.4 | 2.0 | 6.6 | 19.7 | 43.4 |
| 100DFL | 615 805 027 0 | 90 | 198.4 | 100 | 220.4 | 2.0 | 6.6 | 20.9 | 46.1 |



- Reaction free: holds the load weightless throughout the entire cable length
- Rigid and impact-resistant aluminum housing
- 360° swiveling safety hook
- Cable extension limit stop for overload protection
- Screw-type safety hook for load suspension
- Standard spring fracture safeguard, integrated drum lock
- Ferrule for securing cable end
- Freewheel device for protection against handling errors

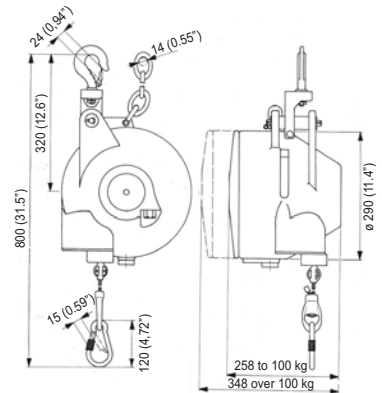

Max.
200 kg (441lb)

BALANCERS - 115DFL - 200DFL

| MODEL | PART NUMBER | LOAD RANGE | | | | CABLE TRAVEL | | WEIGHT | |
|--------|---------------|---------------|-------|---------------|-------|--------------|-----|--------|-------|
| | | MIN. CAPACITY | | MAX. CAPACITY | | m | ft | kg | lb |
| 115DFL | 615 805 028 0 | 100 | 220.4 | 115 | 253.5 | 3.0 | 9.8 | 41.8 | 92.1 |
| 130DFL | 615 805 029 0 | 115 | 253.5 | 130 | 286.6 | 3.0 | 9.8 | 43.2 | 95.2 |
| 140DFL | 615 805 030 0 | 130 | 286.6 | 140 | 308.6 | 3.0 | 9.8 | 44.6 | 98.3 |
| 150DFL | 615 805 031 0 | 140 | 308.6 | 150 | 330.7 | 3.0 | 9.8 | 46.0 | 101.4 |
| 170DFL | 615 805 032 0 | 150 | 330.7 | 170 | 374.8 | 3.0 | 9.8 | 46.4 | 102.3 |
| 180DFL | 615 805 033 0 | 170 | 374.8 | 180 | 396.8 | 3.0 | 9.8 | 46.7 | 102.9 |
| 190DFL | 615 805 034 0 | 180 | 396.8 | 190 | 418.9 | 3.0 | 9.8 | 47.0 | 103.6 |
| 200DFL | 615 805 035 0 | 190 | 418.9 | 200 | 440.9 | 3.0 | 9.8 | 47.3 | 104.2 |

Accessories

Desoutter provides a wide range of accessories to help our customers use their tools as efficiently as possible.



Air preparation units



Polyurethane hose



Air-Flex Swivel connector



Hose reel

Air line accessories such as air preparation units (filter, regulator, and lubricator), fittings, polyurethane hoses, and hose reels.



Ergonomics is a growing concern for many manufacturers and Desoutter offers a selection of products to improve the working environment of the operator on an assembly line: torque arms, bench kits, tool holsters and balancers.

For more information on tools and accessories please visit our website or ask your local representative for a copy of our latest Desoutter general catalogue.



More Than Productivity